

**COUPLER KEY RETAINING COMPONENTS**

ITEM	FMI	ASF KEYSTONE	AH
1	87.21693	7670	AH-8099
2	87.21699	7778	AH-8067
3	87.21581	12015	<del>AH-8080</del> AH-8081
4	87.21696	7786	AH-8066
5	87.21694	070L289900	AH-8072
6	87.21697	0POL221209	AH-8101
7	87.14334	11536	AH-8073

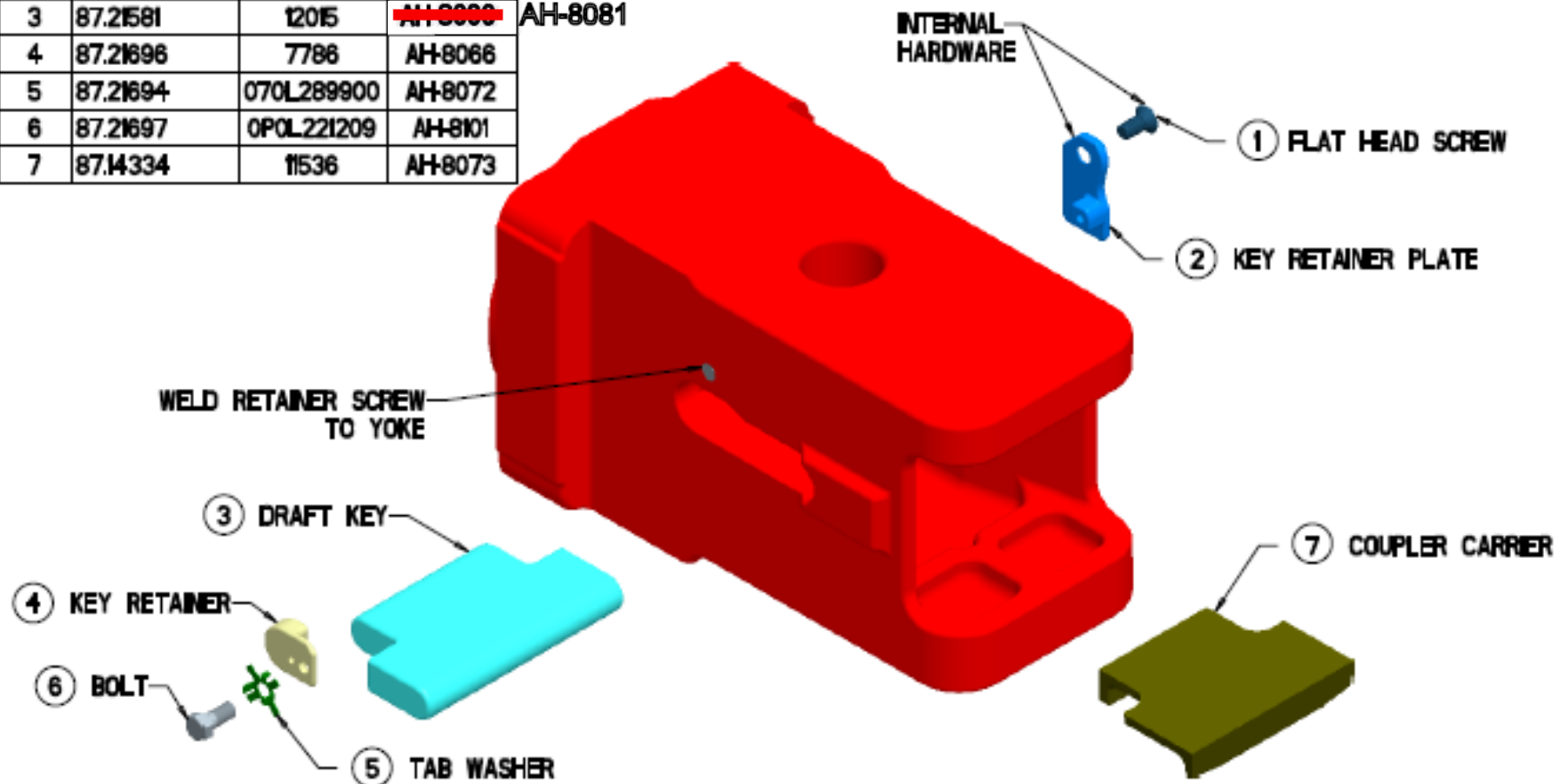

INSTALL COUPLER, DRAFT KEY, KEY RETAINER, TAB WASHER AND BOLT, TORQUE TO 25 FT/LBS, BEND AT LEAST (3) TABS OVER ONTO THE FLATS OF THE BOLT.

COUPLER RETENTION INSTALLATION PROCEDURE FOR E10 & E15 GR STYLE APPLICATION

SKC3766

~~AH-8080~~ | AH-8081